

HSE RoHS

SPECIFICATIONS

Rated Current: 1.0AMP
 Contact Resistance: 20mΩ Max
 Withstand Voltage: 500V AC/DC
 Insulation Resistance: 1000MΩ Min
 Operation Temperature: -40°C to +105°C

Contact Material: Phosphor Bronze
 Contact Plating: Tin Plated
 Insulator Material: Polyester (UL94V-0)

Standard: LCP
 Max. Processing Temp: 230°C for 30-60 seconds
 (260°C for 10 seconds)

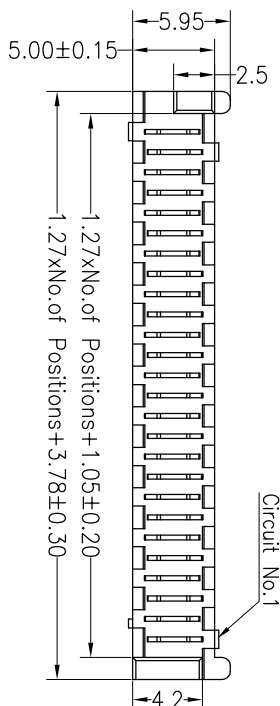

Recommended P.C.B Layout (Top Side)
 (PCB BOARD TOLERANCE ±0.05)

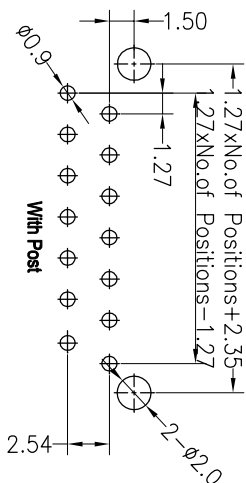
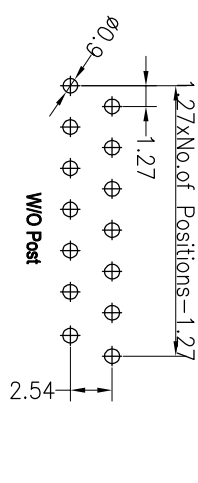

Ordering Information

4100 XX M S SM F X X 01

No. of Pins 04~26P
 Connector Type S=Straight
 Contact Plating SN: Tin SM: Matte-Tin
 Post W=With Post N=W/O Post
 Packing T=Tube R=Reel+Cap

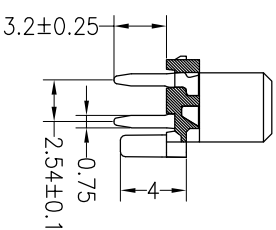
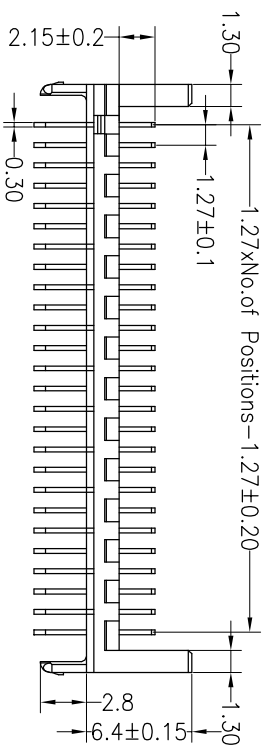

		OPERATION		DRAW		BEN		16.12.09		SCALE		FIT		深圳市锦凌电子有限公司 SHENZHEN JINLING ELECTRONIC CO.,LTD Tel: 86-755-2997-5806/5802 Fax: 86-755-2997-5992			
				CHECK						UNIT		mm					
				±0.30						SIZE		A4		PART NO. 4100XXMSSMFX01			
				±0.20						SHEET		1/1					
A0		2016.12.09		NEW DRAWING						PROU.		1/1		TITLE: 1.27 Picoflex Header Connector DIP (1.27Pitch DC公插DIP)			
REV		DATE		MODIFICATION DESCRIPTION		CHANGE		DIM		TOL		APPROVE					
1		2		3		4		5		6		7		8		9	