

HSE RoHS

Insulator type: Open frame

| No. of Positions | B | C |
|------------------|-------|-------|
| 16 | 7.62 | 10.16 |
| 20 | 10.16 | 12.7 |
| 24 | 10.16 | 12.7 |
| 28 | 10.16 | 12.7 |
| 30 | 10.16 | 12.7 |
| 32 | 10.16 | 12.7 |
| 48 | 10.16 | 12.7 |

| | | |
|----|-------|-------|
| 20 | 15.24 | 17.64 |
| 24 | 15.24 | 17.64 |
| 28 | 15.24 | 17.64 |
| 40 | 15.24 | 17.64 |
| 42 | 15.24 | 17.64 |
| 48 | 15.24 | 17.64 |
| 52 | 15.24 | 17.64 |
| 56 | 15.24 | 17.64 |
| 64 | 15.24 | 17.64 |
| 68 | 15.24 | 17.64 |

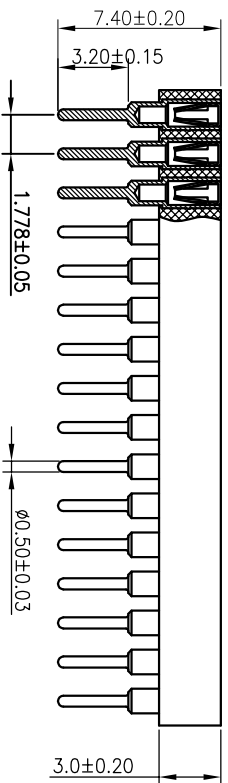
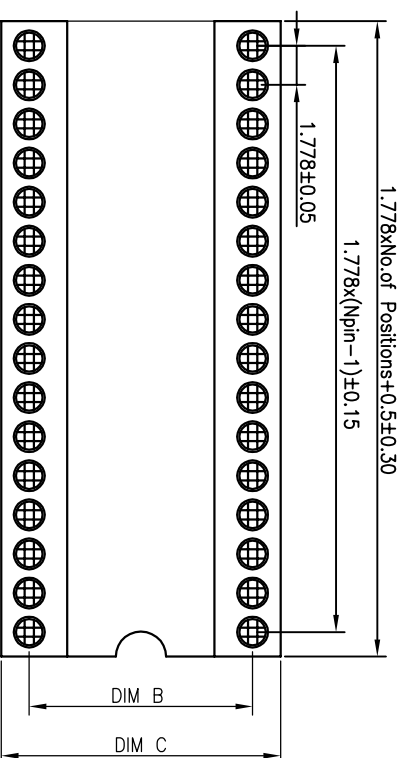

Ordering Information

7220 30 X XX S XX 074 X 1

N=7.62PH
 E=10.16PH
 W=15.24PH
 No. of Pins 16~64Pins
 Contact Plating
 SN:Tim
 G0:Gold Flash
 G2:2U"Gold
 G3:3U"Gold
 G4:5U"Gold
 G5:10U"Gold
 S0:Gold Flash/Tin StandardG0
 Pin Length 074=7.40mm
 Packing 0=Pe Bag T=Tube

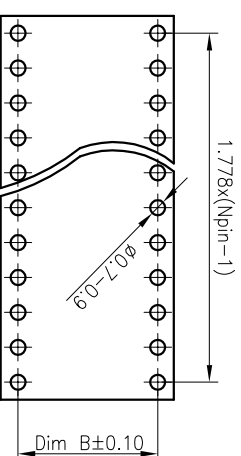
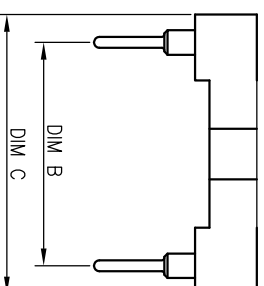

Recommended P.C.B Layout(Top Side)

Technical Specs:

Insulator: Black glass filled polyester PPS
Flammability: UL 94V-0
Sleeve: Brass CuZn36Pb3(C36000)
Contact clip(4 finger): Beryllium copper(C17200)
Accepted pin: Ø0.40 to 0.56mm
Forces: (polished steel gauge Ø0.43mm)
 --Insertion 2 N typ
 --Withdrawal 1 N typ
Mechanical life: min 100 cycles
Rated current: 1.0AMP
Contact resistance: max 10mΩ
Dielectric resistance: Min 1000MΩ
Operating temperature: -40°C+105°C
Soldering temperature: 260°C, 10s max

| OPERATION | DRAW | YTuSheng | 14.03.28 | SCALE | FIT | UNIT | mm | SIZE | A4 | SHEET | 1/1 | TITLE: | 1. 778x3. 0 Machine Pin IC Socket L=7. 40mm |
|--------------------------|-------|----------|----------|-------|-----|------|----|------|----|-------|-----|--------|---|
| X.X | ±0.30 | | | UNIT | mm | | | | | | | | |
| X.XX | ±0.20 | CHECK | | SCALE | FIT | UNIT | mm | SIZE | A4 | SHEET | 1/1 | TITLE: | 1. 778x3. 0 Machine Pin IC Socket L=7. 40mm |
| X.XXX | ±0.10 | | | PROL. | | | | | | | | | |
| ANGLE | ±3° | APPROVE | | | | | | | | | | | |
| DIM | TOL | | | | | | | | | | | | |
| CHANGE | | | | | | | | | | | | | |
| MODIFICATION DESCRIPTION | | | | | | | | | | | | | |
| DATE | | | | | | | | | | | | | |
| 2014.03.28 | | | | | | | | | | | | | |
| NEW DRAWING | | | | | | | | | | | | | |

JILIN 深圳市锦凌电子有限公司

SHENZHEN JINLING ELECTRONIC CO.,LTD

Tel: 86-755-2997-5806/5802 Fax: 86-755-2997-5892

PART NO. 722030XXXXXX074X1

TITLE: 1. 778x3. 0 Machine Pin IC Socket L=7. 40mm